

Installation Instruction

Product Code: GBGMHOEMWH
Product Description: LED Emergency Bulkhead

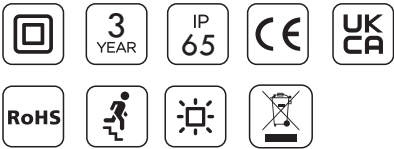

Specification

Charge Power: 4.5W
Discharge Power: 10W
EM Duration: 3 hours
Ambient Temp: 5-45°C
Emergency Mode: Non-Maintained
Function: Standard
Battery: LiFePO₄ 6.4V 6.6Ah
Warranty: 3 years

Routine Testing

- Testing should be carried out in accordance with the recommendations of BS5266 & EN50172.
1. Do not switch off unswitched mains supply after installation. If interruption is unavoidable, the batteries must be disconnected or damage to the batteries may occur. Leave the luminaire on continuous charge for 24 hours.
 2. A monthly functional test should be conducted manually.
 3. Annually, a full three hour duration test should be conducted manually.
 4. Batteries should be replaced when the luminaire no longer meets the 3 hours duration performance.
 5. Testing is performed by interrupting the unswitched supply for the test duration manually.
During testing the luminaire should remain illuminated in emergency mode.
 6. Ensure that the 'charge indicator' is 'ON' during 'Charging Mode'.
If the charge indicator (LED) is unlit, this signifies a fault.
 7. Replace faulty light source and batteries immediately.
To assist with this testing, a test record is included below.
To increase the chance of a fault being reported between monthly tests, it is desirable that staff are made aware of the purpose of the indicator.

Testing Record

Product: _____ Location: _____ Installation Date: _____

Month	Functional/Duration	Year 1	Year 2	Year 3	Year 4	Year 5
1						
2						
3						
4						
5						
6						
7						
8						
9						
10						
11						
12						

Installation Instruction

Dimension

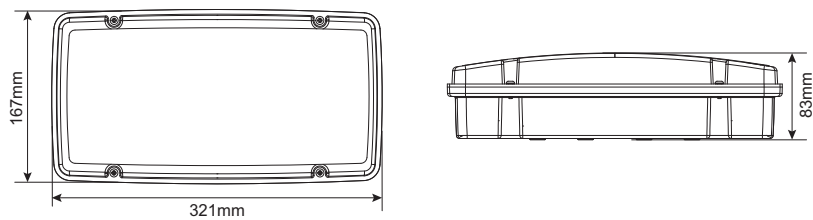

1

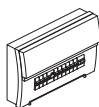

ALWAYS SWITCH OFF THE
MAINS SUPPLY BEFORE
INSTALLATION OR SERVICING

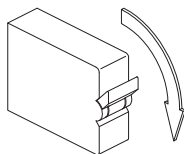

2



x4

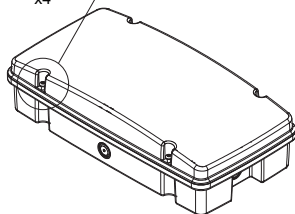

3

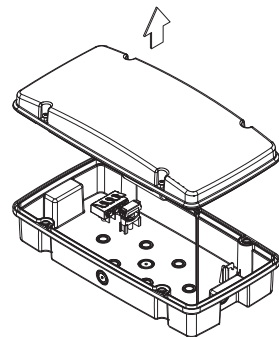

4

Model A



Drill hole in base tray

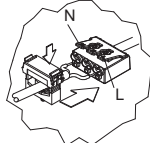
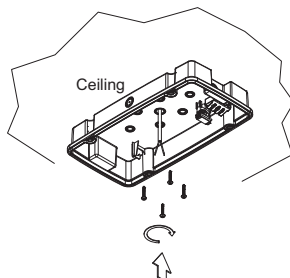

Model B



Drill hole in base tray

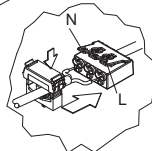
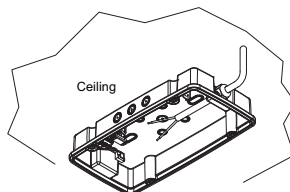

Installation Instruction

5

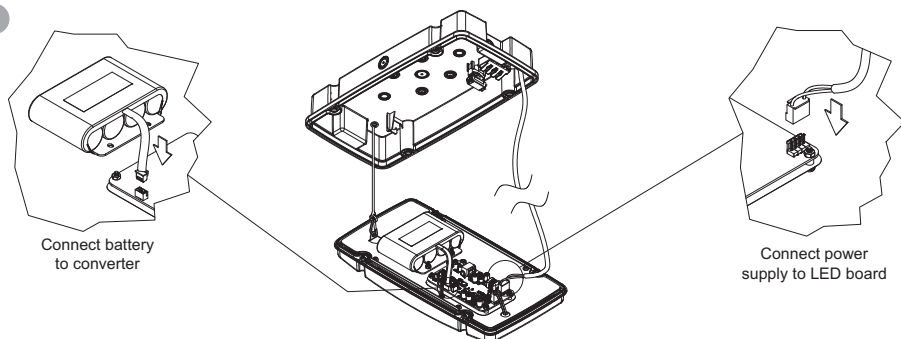

6

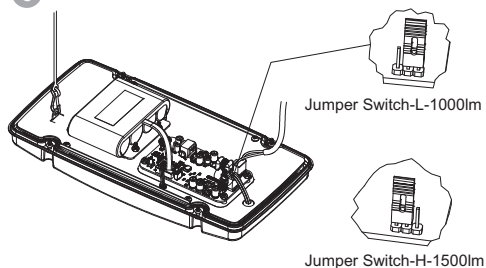

7

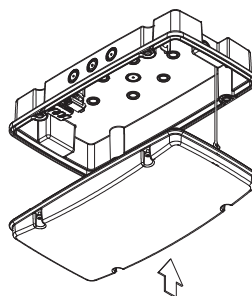

8

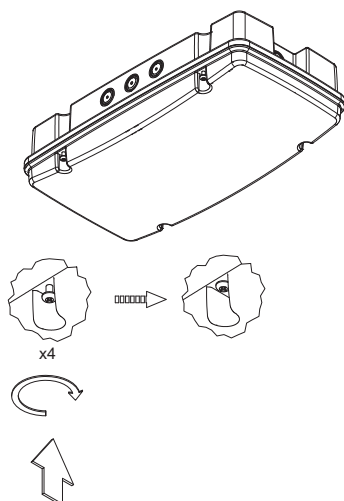

9

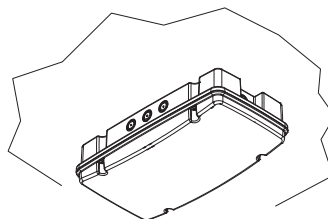

10

