

SOCKET CONVERTORS & EXTENSION LEAD

- 13A

GB122W1

- + Easily converts a single socket into a twin socket
- + Supplied with 2 X M3.5 screws to fit existing wall box
- + Quick & easy to fit

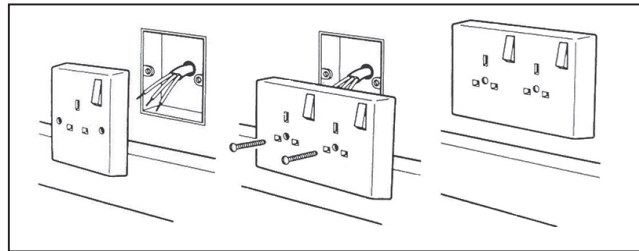

GB223W-C

- + Easily converts a twin socket into a triple socket
- + Supplied with 2 X M3.5 screws to fit existing socket wall box
- + Quick & easy to fit

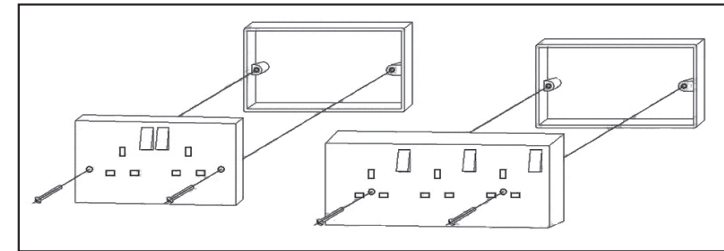
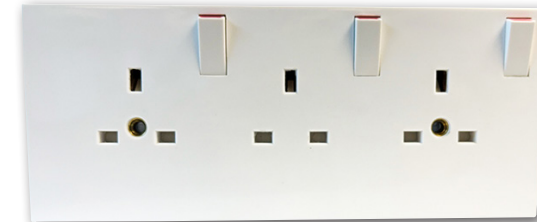

1119

- + 4 Gang extension lead, with Neon indicator
- + 1 Year Guarantee

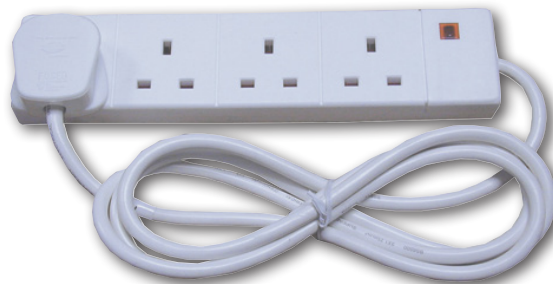

	GB122W1	GB223W-C	1119
Description	1 to 2 Socket Converter	2 to 3 Socket Converter	4 Gang Extension Lead with Neon indicator & 2M cable (approx)
Barcode	5012739654916	5012739607691	5012739611773
Voltage	230-240V ~ 50/60Hz		13 Amp (250 AC)
Max Operating Current	13A		13A (fuse supplied)
Terminal Holes	3 x 2.5mm ² Single or Stranded Cable		-
Main Housing Material	White Urea		White Urea
IP Rating	IP20		
Class Type	1		
Dimensions (mm)	H85 x W145 x D23mm (D = Front Plate Depth)	H87 x W210 x D25mm (D = Front Plate Depth)	H53 x W250 x D26mm
Product Weight	196g	290g	357g
Guarantee	1 Year		
Conforms To	BS 1363-2:2016+A1:2018		BS 1363