

# POWER & EXTENSIONS SOLUTIONS

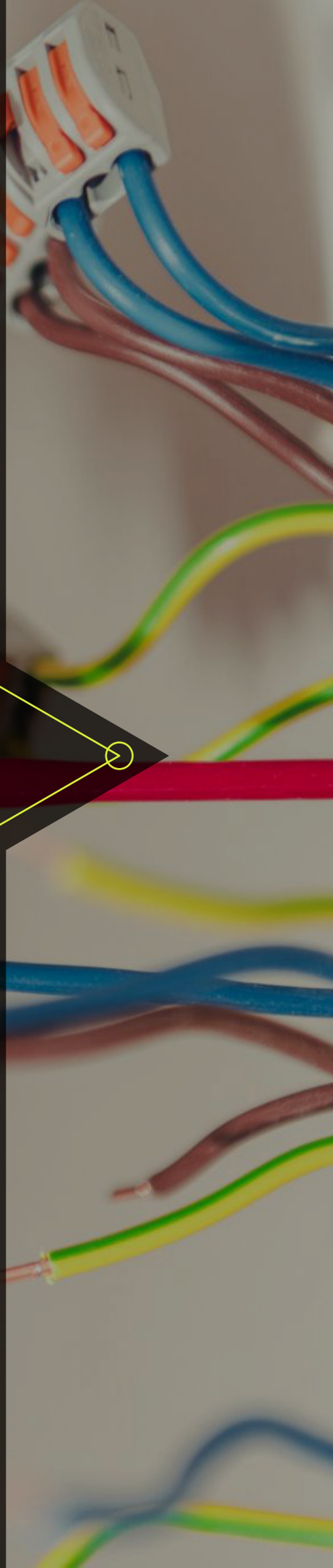
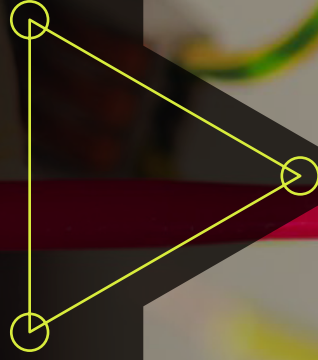

# Socket Converters & Extension Leads

This range of Socket Converters are an ideal way of gaining extra sockets the GB122W converts a single socket into a twin, and the GB223W converts a twin socket into a triple.

✓ **1 Year Guarantee**

TECHNICAL INFORMATION	
Conforms to	BS 1363

## 1 to 2 Socket Converter



**GB122W1**

**Box Packed**

**1 to 2 Socket Converter**

Converts a single socket to a twin

Replaces existing single socket

Pack Qty 1

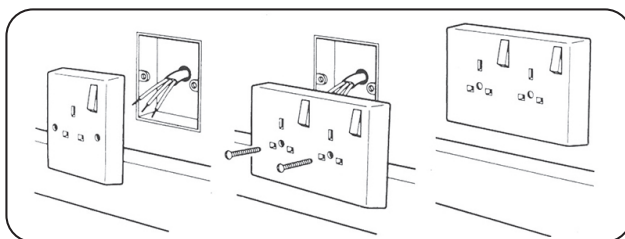

## 2 to 3 Socket Converter

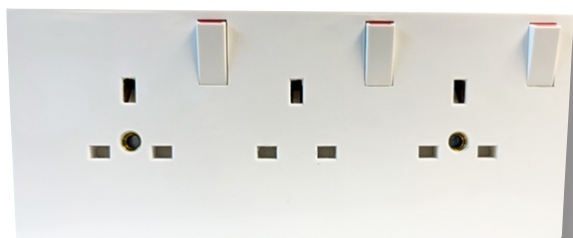

**GB223W**

**2 to 3 Socket Converter**

Converts a Twin Socket to a triple Socket

Clam Packed

Pack Qty 5

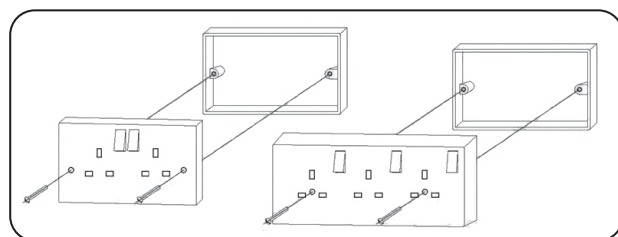

## 4 Gang Extension Lead

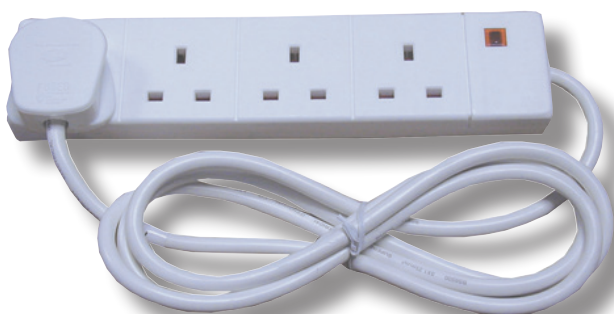

**1119**

**13A, 4 Gang Extension Lead with neon power-on Indicator**

1.6M cable

Poly bag packed

Pack Qty 1

# Plug Tops

- ✓ Solid brass pins
- ✓ Screw down cable clamp
- ✓ Tough nylon construction
- ✓ 1 Year Guarantee

TECHNICAL INFORMATION	
Conforms to	BS 1363



**PT13WN**  
**13A Plug Top**  
White  
Pack Qty 20



**PT13BN**  
**13A Plug Top**  
Black  
Pack Qty 20



**PT13W-5AN**  
**13A Plug Top**  
Supplied with a 5A Fuse  
White  
Pack Qty 20



**PT13B-5AN**  
**13A Plug Top**  
Supplied with a 5A Fuse  
Black  
Pack Qty 20



**PT13W-3AN**  
**13A Plug Top**  
Supplied with a 3A Fuse  
White  
Pack Qty 20



**PT13B-3AN**  
**13A Plug Top**  
Supplied with a 3A Fuse  
Black  
Pack Qty 20

# Fuses



<b>2AF</b>	2A
<b>3AF</b>	3A
<b>5AF</b>	5A
<b>7AF</b>	7A
<b>10AF</b>	10A
<b>13AF</b>	13A

Cartridge Fuses with ceramic body  
1" long  
Conforms to BS 1362  
Pack Qty 100

# Euro & Schuko Converter Plugs

The Europlug converts 2.5A Europlug and German Schuko to 13A BS type.

The Europlug clips into the 13A Euro converter plug terminals quickly and securely making life easier for UK consumers or importers buying standard electrical equipment abroad.

There is a choice of **Non Returnable** (tamper-proof) this refers to the screws used to secure the plug cover.

- A non returnable screw can only be screwed in once and will not undo for security/ safety purposes.

Or **Returnable**

- A returnable screw can be screwed and unscrewed as many times as required.

✓ **1 Year Guarantee**

TECHNICAL INFORMATION	
Conforms to	BS 1363, BS 5733



**ECP-WNR-3A**  
**3A Non Returnable**  
 White  
 Pack Qty 1



**ECP-BNR-3A**  
**3A Non Returnable**  
 Black  
 Pack Qty 1



**ECP-BNR-5A**  
**5A Non Returnable**  
 Black  
 Pack Qty 1



**ECP-WR-3A**  
**3A Returnable**  
 White  
 Pack Qty 1



**ECP-BR-5A**  
**5A Returnable**  
 Black  
 Pack Qty 1



**SCP-B-10A**  
**Schuko Converter Plug 10A**  
**Non earth converter**  
 Black  
 Pack Qty 1



**SCP-B-13A**  
**Schuko Converter Plug**  
 13A  
 Black  
 Pack Qty 1

# Trailing Sockets

- ✓ Available in 1 and 2 gang
- ✓ 1 Year Guarantee

TECHNICAL INFORMATION	
Conforms to	BS 1363

## 2 Gang Trailing Socket

### TS2W

#### Trailing Socket - Rubber

2 Gang

White

Pack Qty 10



### TS2B

#### Trailing Socket - Rubber

2 Gang

Black

Pack Qty 10



## 1 Gang Trailing Socket

### TS1W

#### Trailing Socket - Rubber

1 Gang

White

Pack Qty 10



### TS1B

#### Trailing Socket - Rubber

1 Gang

Black

Pack Qty 10



# NOTES