

TECHNICAL INFORMATION

Rated Voltage:	230V~50Hz
IP Rating:	IP65
CRI:	>80
Class Type:	II
Beam Angle:	120°
Housing:	Polycarbonate Opal diffuser & base
Battery:	Ni-Cd 3.6V/ 2000mAh
Operating Temp:	Min -10°C to Max +40°C
Colour Temperature:	4,000K
SDCM:	<6
Conforms To:	BS EN60598-1 & BS EN60598-22

NOVA14 Range

Lumens Output:	1100 lumens
NV14	92 lm/W
NV14EM	79 lm/W
NV14M	85 lm/W
NV14EMM	73 lm/W
Dimensions:	294.8 diameter x 90mm

NOVA22 Range

Lumens Output:	2200 lumens
NV22	105 lm/W
NV22EM	96 lm/W
NV22M	102 lm/W
NV22EMM	94 lm/W
Dimensions:	370.4 diameter x 90.2mm

Microwave Presence Detector Fittings

Mode of operation:	Maintained
Lux Level:	2, 10, 50 Lux or disable
Detection Range:	10M dia x 6M high
Installation Max Height:	6 Metres
Detection Angle:	30° - 150°
Time Delay:	5 secs, 90 secs, 5 mins, 15mins

GUARANTEE
Your GreenBrook IP65 Circular Bulkhead is guaranteed for 3 years from the date of purchase. This is in addition to your statutory rights.

PLEASE KEEP THESE INSTRUCTIONS SAFE FOR FUTURE REFERENCE

GREEN BROOK
ELECTRICAL
WEST ROAD . HARLOW
ESSEX . CM20 2BG . UK
info@greenbrook.co.uk
www.greenbrook.co.uk



GREEN BROOK
ELECTRICAL

Installation Instructions for:- 'Nova14 & Nova22' Range - LED IP65 Emergency Circular Bulkheads

Model Numbers -

NV14EM 14W Emergency
NV14EMM 15W Emergency & Microwave Presence Detector

Model Numbers -

NV22EM 21W Emergency
NV22EMM 24W Emergency & Microwave Presence Detector

These instructions should be carefully read before and retained after installation for future reference. Microwave presence detectors are designed to reduce the amount of time lighting is left on unnecessarily, for example if an area is unoccupied or if there is sufficient natural light. A presence detector monitors the detection zone for occupancy, using radio waves in the microwave band (5.8 GHz) if a person is sensed then the detector will automatically turn the lighting on. When the area is vacated, the lighting will turn off after a preset time delay. Most microwave sensors have a built in programmeable light level (lux) sensor which will keep the lighting off if there is enough natural light available. This model can also be disabled so the light will always switch On or Off regardless of light level.

IMPORTANT

This product should be installed by a competent person and in accordance with the current IET Wiring Regulations. If in doubt, consult a qualified electrician.

SAFETY INFORMATION

- Before installation or maintenance please ensure that the mains supply is switched off and the circuit supply fuses are removed or circuit breaker turned off.
- An IP65 rating means this fitting is suitable for outdoor applications.
- Check with your local authority for recycling advice.
- This product contains a light source of energy efficiency class A.

INSTALLATION

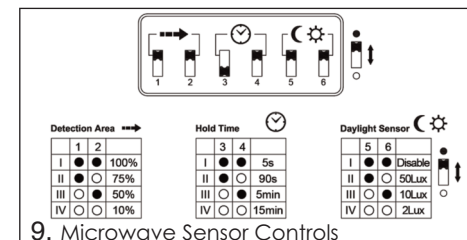
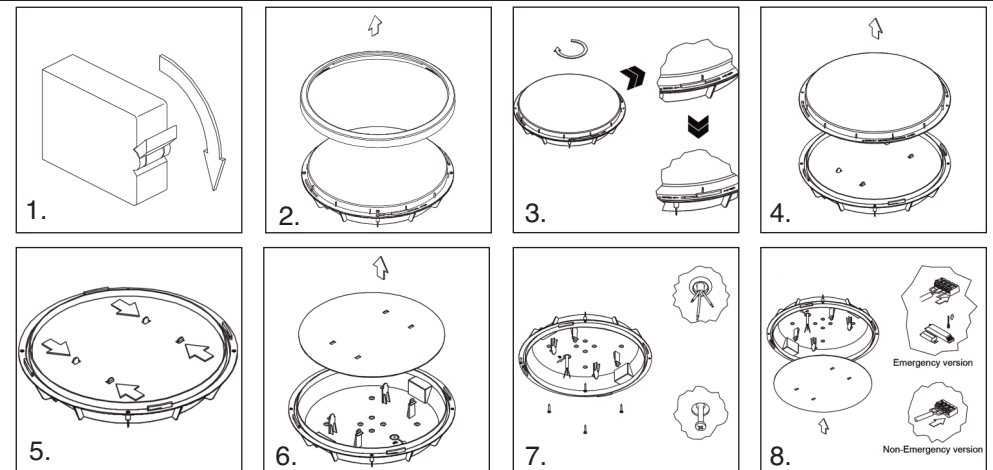

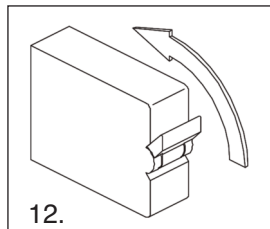
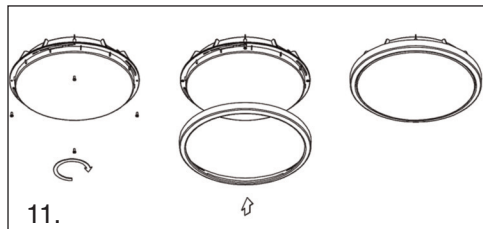
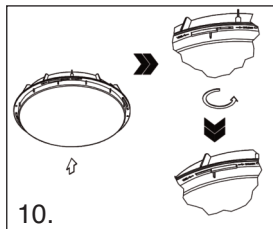

WIRING INSTRUCTIONS

- Terminal (SL):** This is the switched live supply and can be used to illuminate the lamp either via a separate switched LIVE or by using a link wire between PL and SL for permanent illumination.
- Terminal (PL):** This is the live supply to the charging circuit and must be permanent and unswitched.
Connect this only for non-maintained lights (SL not required).
- Terminal (E):** This is for the earth and must be connected.
- Terminal (N):** This is the neutral supply and must be permanent.
- Colour code:** Brown=Live Blue=Neutral Green/Yellow=Earth
Conductor Size 0.75mm² - 1.5mm² Solid or Stranded.
Ensure that no strands of bare wire have escaped the terminals.

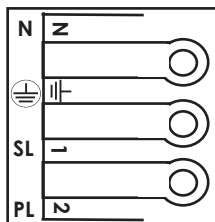

Note: Ensure to connect the battery for emergency use.

COMMISSIONING & TESTING

- Switch on the mains supply and check to ensure that the green LED battery charging indicator is illuminated.
- Allow a brief time for initial partial charging and then isolate the permanent live supply by removing the fuse from the fused spur box. Check to ensure the lamp is then illuminated from the battery cell pack supply, replace fuse.
- After a further 60 hours on a continuous charge, and only at a safe and appropriate time, mains failure should be simulated to ensure that full duration rating is achieved. Thereafter the re-charge time is 24 hours.

MAINTENANCE

- Servicing should only be carried out after the luminaire has been made electrically safe.
- Cleaning should be carried out at regular intervals to ensure that dirt does not accumulate to an extent that will impair the electrical and / or thermal safety of the luminaire. Regular cleaning will also ensure that the optical performance is maintained.
- Battery packs should be replaced when the luminaire fails to meet its rated duration.
- The disposal of components from the luminaire may require consultation with local authorities. The disposal of batteries is subject to Local Authority Regulations, and the By-Laws Department for disposal of toxic waste should be consulted for specific guidance. Battery cell packs must not be incinerated.
- Do not dispose with household waste, subject to conditions in the WEEE directive.

ROUTINE INSPECTION & TEST PROCEDURE

All tests should be undertaken during daylight hours at times of minimum risk and be in accordance with the recommendations of BS 5266 Part 1.

DAILY - Check that the green LED battery charging indicator is illuminated and every lamp in a maintained system is functioning correctly.

MONTHLY - In addition to the daily check, a functional test through simulation of mains supply failure should be carried out to confirm lamp is illuminated from the battery cell pack supply. This test need only be for approximately 30 seconds. It should not exceed one quarter of the rated luminaire duration.

SIX MONTHLY - In addition to the monthly test, the lamp should be illuminated from the battery cell pack supply for a continuous period of at least one hour.

THREE YEARLY - In addition to the monthly tests the lamp should be illuminated from the battery cell pack supply for the full rated duration of the luminaire(three hours).

ANNUALLY THEREAFTER - As above, i.e, check that the luminaire operates for the full rated duration.

At the end of each test period the mains supply should be restored and a check made to ensure the green LED battery charging indicator is illuminated.

Battery cell packs should be replaced once the rated duration can no longer be met.

EMERGENCY RECESSED LIGHT TEST RECORD SHEET

LUMINAIRE TYPE/REF: _____

DATE OF INSTALLATION: _____

LOCATION: _____

1st Year 2nd Year 3rd Year 4th Year 5th Year

Month	Test	Signed Date	Signed Date	Signed Date	Signed Date	Signed Date
1	FUNCTIONAL					
2	FUNCTIONAL					
3	FUNCTIONAL					
4	FUNCTIONAL					
5	FUNCTIONAL					
6	FUNCTIONAL					
7	FUNCTIONAL					
8	FUNCTIONAL					
9	FUNCTIONAL					
10	FUNCTIONAL					
11	FUNCTIONAL					
12	THREE HOUR					
	FUNCTIONAL					